

Kalix – Expansion Tank Installation

Parts List			
Ref	Description	Part Number	Quantity
A	Expansion tank	034987-001	1 pc
B	Fitting JG 3/8 tube x 1/2 BSP	037005-001	1 pc
	Reducer 3/8 stem – 1/4 tube	030552-101	1 pc
C	Tee-piece	029199-003	1 pc
D	Tubing, 1/4"	029959-002	1 pc x 4cm
			1 pc x 6cm
E	Bracket, Expansion Tank	034988-001	1 pc
F	Screw	026642-023	2 pcs
G	Cable Tie	024070-005	2 pcs
H	Solenoid Valve	034613-002	1 pc
I	Spout	034625-001	1 pc
J	Mesh	034836-001	1 pc
K	O-Ring	030858-220	1 pc

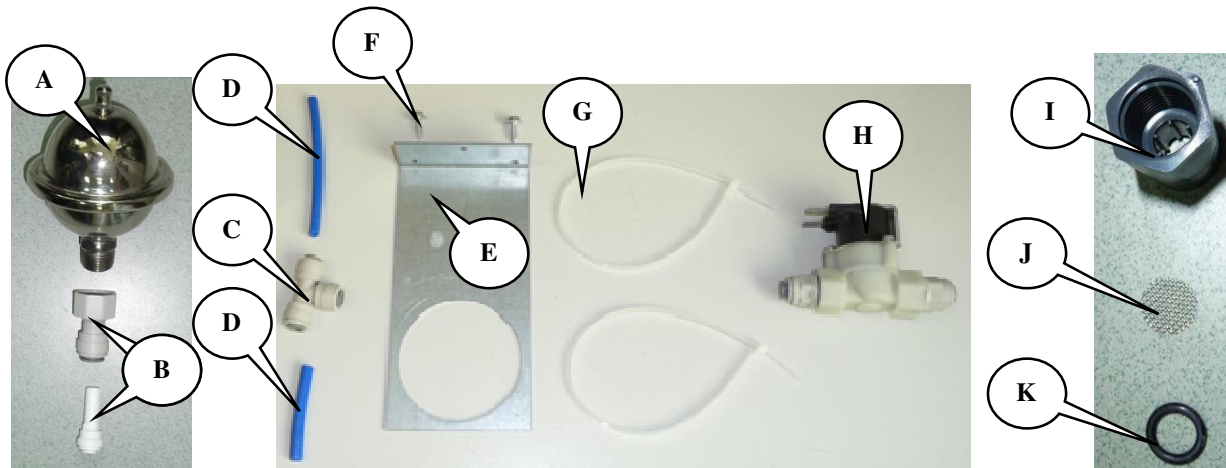

STAGE 1: INSTALL EXPANSION TANK

1. Disconnect unit from water and power supply.
2. Disassemble the unit:
 - a. Remove 2 x screws at the back of the moulded top
 - b. Remove moulded top
 - c. Disconnect the tube marked on the photo below from the solenoid valves – to disconnect press flange on the pipe connector.

Kalix – Expansion Tank Installation

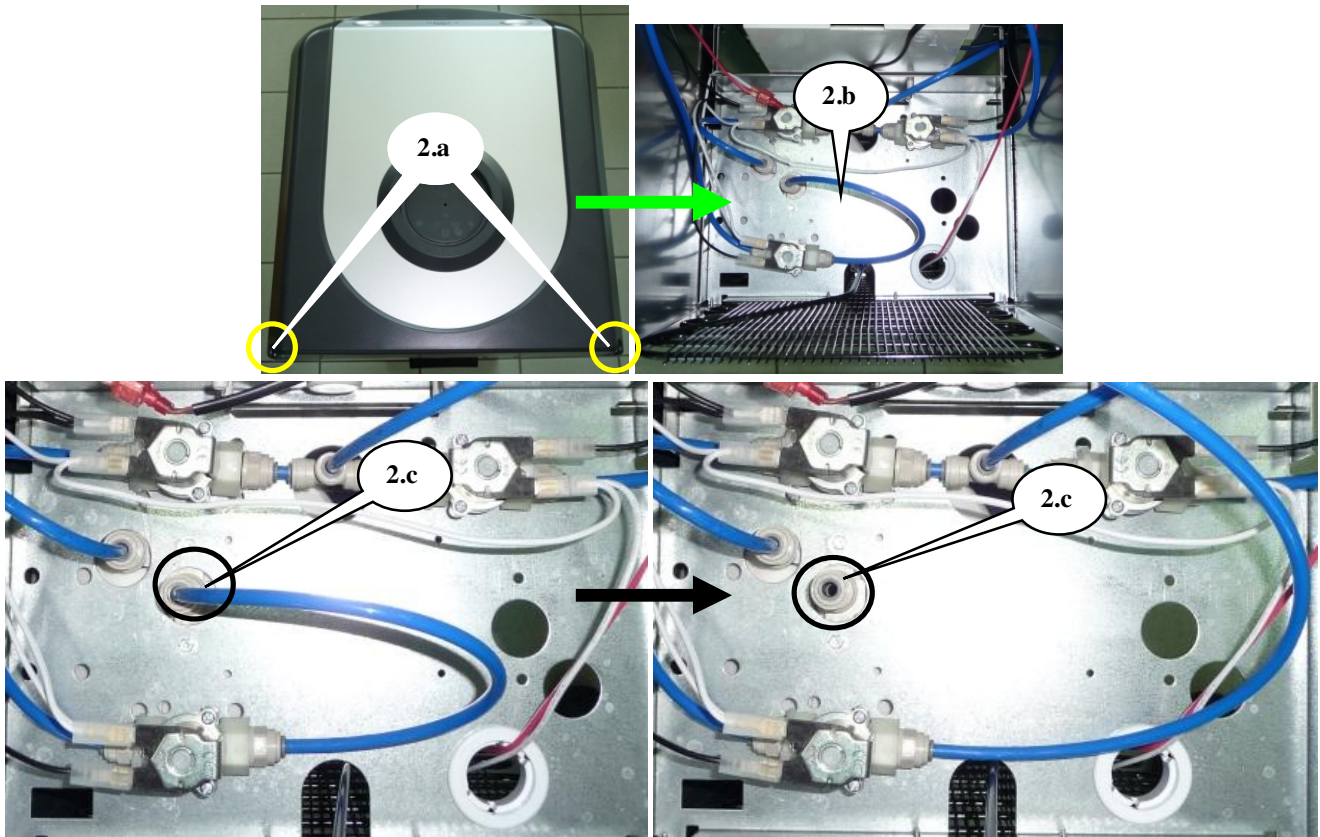

3. Assemble expansion tank:

- a. Attach fitting and reducer "B" to expansion tank "A". Connect the two lengths of blue tube to the Tee-piece. Connect the longer length of tubing to the fitting attached to the expansion tank
- b. Fit expansion tank assembly to the mounting bracket

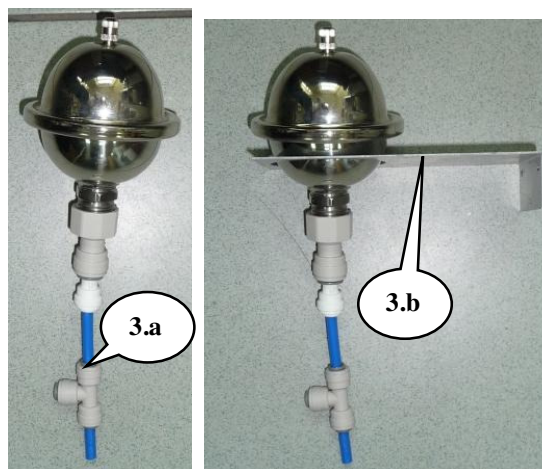

Kalix – Expansion Tank Installation

4. Install expansion tank:
 - a. Attach the loose tube on the expansion tank assembly to the fitting in the position marked on the photo
 - b. Attach the expansion tank bracket to the condenser with two screws
 - c. Connect the tube disconnected at step 2c to the open connection on the Tee-piece

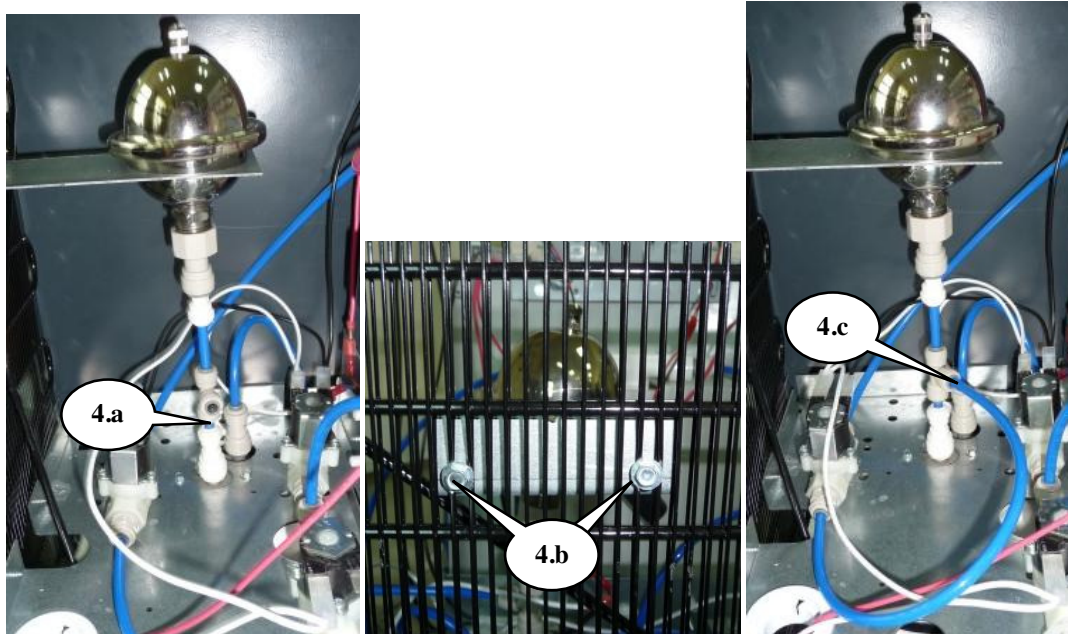

STAGE 2: REPLACE SPOUT ASSEMBLY

5. Spout exchange:
 - a. Unscrew existing spout from Kalix,
 - b. Fit mesh to spout
 - c. Install o-ring into spout
 - d. Screw new spout with mesh and o-ring onto Kalix.

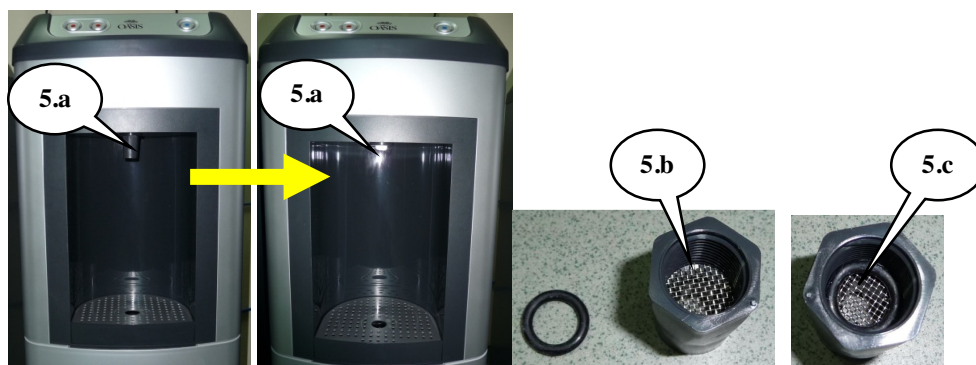

6. Connect unit to water and power supply. Flush some cold water from unit and see if there are any leaks on installed parts (tubes, connections).
7. Refit the moulded top and tighten the 2 screws

Kalix – Expansion Tank Installation

STAGE 3: REPLACE OUTLET SOLENOID

If leaks from spout are still noticeable after the expansion tank has been installed, then the outlet solenoid valve must be exchanged.

1. Disconnect unit from water and power supply
2. Cut two tie cables that hold marked solenoid valve.
3. Disconnect two wires connected to solenoid valve.
4. Disconnect two tubes from solenoid valve.

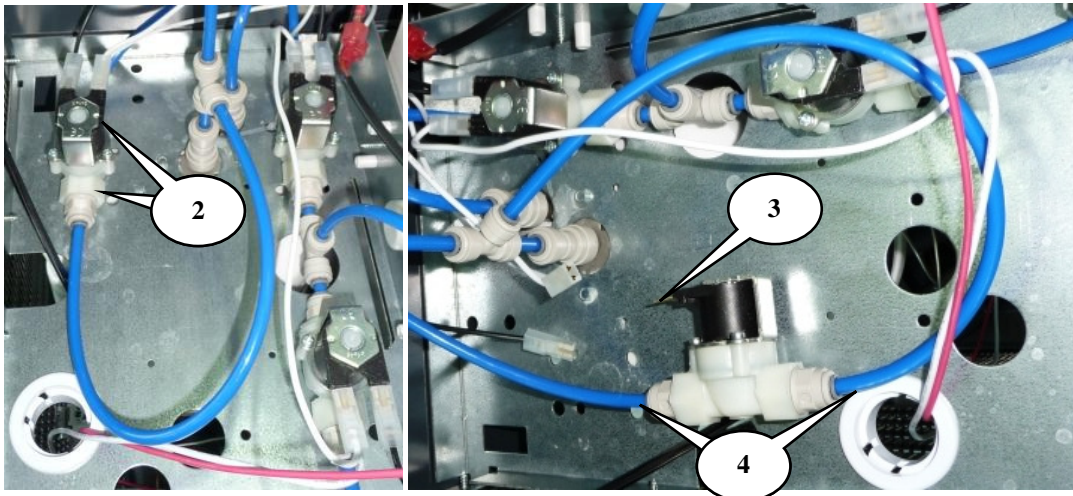

5. Install new solenoid valve. Plug tubes as shown on photo. Servo valve has at the bottom arrow that shows water flow, it must be directed as shown on photo.
6. Connect two wires to solenoid valve.
7. Make sure that new solenoid valve is installed as it is shown on photo – arrow shows water flow.
8. Tighten solenoid valve with two tie cables.

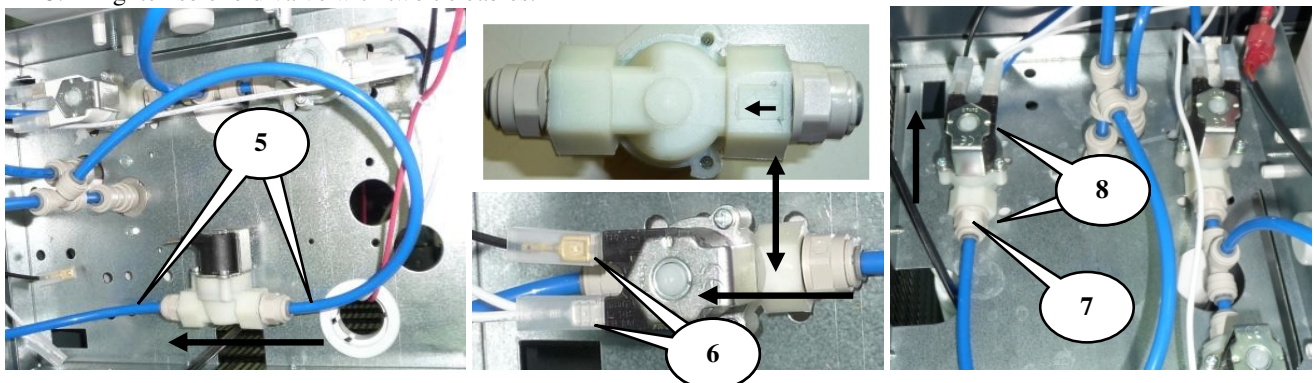

Assemble the unit. Plug to water and power supply. Flush some water to check if it works properly.