

HT3 Assembly

HT3 Assembly for B1RR & B1SR Coolers

A new hot tank assembly has been developed and is now supplied for all B1RR and B1SR water coolers. The new assembly includes a feature that should reduce nuisance service calls – if your customer switches on the hot tank before it is filled with water, then we have added a resettable limiter which will break the electrical circuit before the single-use limiter operates. When the tank cools down, this new limiter will reset itself.

NOTE:

- Although HT2 assemblies are no longer supplied, we will maintain a full inventory of parts for all your service requirements.
- We have changed the finished product part numbers of all hot model B1RR & B1SR coolers to identify units that contain the new HT3. All numbers have been incremented by “100” (i.e. if you previously ordered a 032510-601, you will now be ordering 032510-701)

No	Description	Part Number
1	HT3 Assembly, Complete (230V)	033467-002
2	Heater Pan Assembly	033455-002
3	Hot Tank Head & Body Assembly	033465-002
4	Stamped V-coupling	032729-002
5	Thermostat, Hot Control	033451-002
6	Cover, Thermostat	033452-001
7	Device, Dry Control & Limiter	033459-002
8	Element, Heating	032487-002
9	O-Ring	030858-402
10	Drain Valve Assembly	032817-001
11	Tube, Drain	028715-008
12	Faucet Fitting	032020-001
13	Insulation	033460-001 & -002

Service Instructions

A) Removing the hot tank from the cooler:

1. Disconnect the power supply cord.
2. Draw water from the hot faucet until the water is cool.
3. Remove the bottle from the unit. **CAUTION:** A nearly full bottle of water weighs over 18 kg and can be awkward to handle. It may be necessary for you to drain water from the bottle until it becomes manageable.
4. Drain water from the reservoir through the cold faucet.
5. Place a bucket or pan under the black drain valve located at the rear of the cooler.
6. Turn the valve's petcock counterclockwise to open. **CAUTION: HOT WATER CAN SCALD HANDS.**
7. Turn the drain valve to a closed position when the tank is empty.

HT3 Assembly

8. Remove WaterGuard, faucets & reservoir from the cooler
9. Remove cooler chassis from the cabinet
10. Disconnect wiring to the hot tank (TIP: Unscrew earth connection at metal base, disconnect white wire at heat limiter and red wire from the thermostat at the rocker switch).
11. Remove the two screws fixing the drain valve to the condenser and detach the drain valve from the condenser wires.
12. Undo the two screws that fix the hot tank to the shelf and lift the complete hot tank assembly from the cooler.

B) Replacing the Hot Control

1. Disconnect the power supply cord.
2. Remove the cooler chassis from the cabinet
3. Remove the wire tie that holds the insulation in place & remove the insulation
4. Remove the nut that holds the brass thermostat cover in position
5. Remove the thermostat and disconnect the red and black leads
6. Install the replacement thermostat and reconnect the red and black wires
7. Replace the thermostat cover and refit the nut to fix the cover in place
CAUTION: The nut must be tightened to a torque of 2 Newton.meters (18 in.lb) – use a torque wrench for this operation
8. Replace the insulation, fix in place with the wire tie and refit the chassis into the cabinet.

C) Adjusting the Hot Control

It is possible to adjust the hot water temperature with the hot tank in place in the cooler. Simply use a long flat blade screwdriver to turn the screw adjuster on the control (turn the screw **CLOCKWISE** to **INCREASE** the water temperature).

D) Replacing the Heat Limiter Device

1. Disconnect the power supply cord.
2. Remove the cooler chassis from the cabinet
3. Disconnect the two wires to the heat limiter (white wire from compressor, black wire connected at heating element)
4. Loosen the P-Clamp
5. Remove the heat limiter from the hot tank
6. Insert the replacement heat limiter into the hot tank
CAUTION: Underneath the heat shrink tubing that protects the limiter, there is a “smooth” face and a “bumpy” face – ensure that the “smooth” face is **INTO** the hot tank.
7. Refit the P-clamp and reconnect the wiring to the heat limiter.

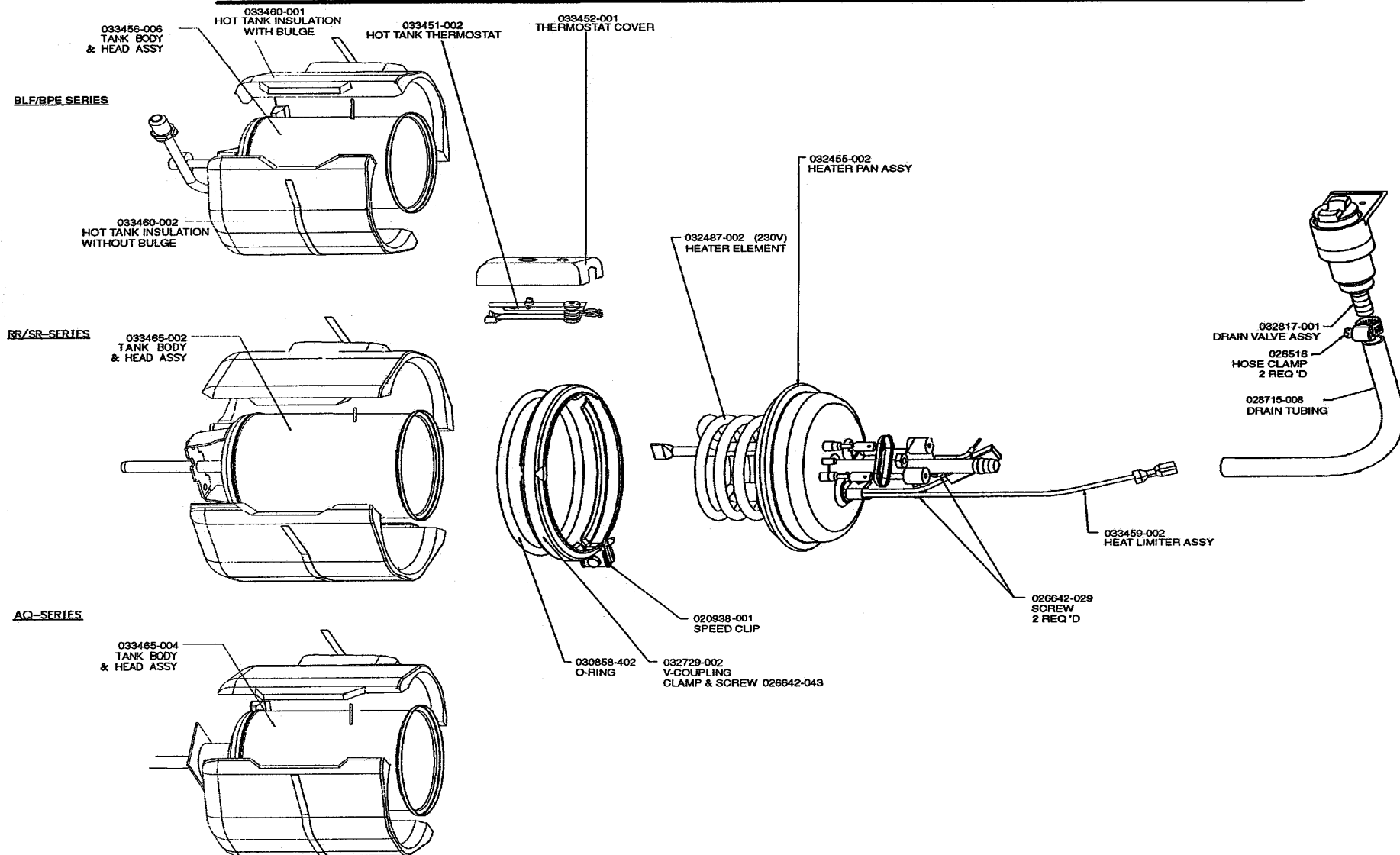

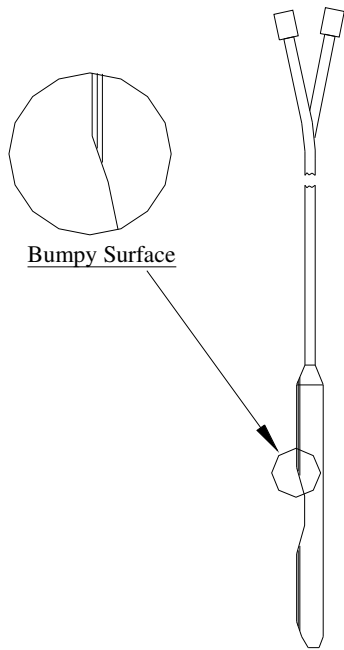
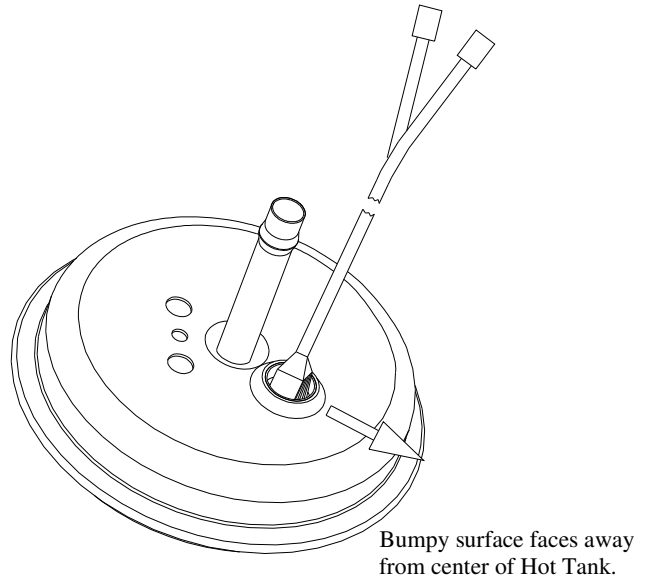
Dry Control and Limiter DeviceAssembly of Dry Control and Limiter Device in Hot TankHot Control Thermostat